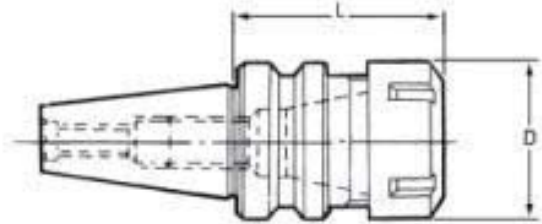
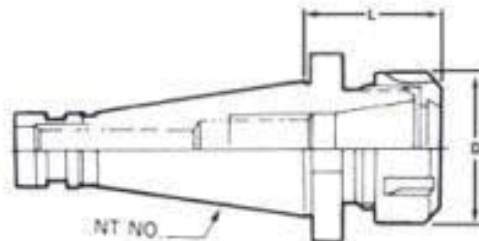

ER Collet Chuck (for CNC Machine)
BT Series

| Model No. | Clamping Range | L mm | D mm | Collet Type | Price |
|------------------|----------------|---------|---------|-------------|------------|
| | mm | | | | Baht |
| AW/BT30-ER16-060 | 0.5 - 10 | 60 | 28 | ER16 | ฿ 1,900.00 |
| AW/BT30-ER20-060 | 0.5 - 13 | 60 | 34 | ER20 | ฿ 1,900.00 |
| AW/BT30-ER32-060 | 1.0 - 20 | 60 | 50 | ER32 | ฿ 1,900.00 |
| AW/BT40-ER16-070 | 0.5 - 10 | 70 | 28 | ER16 | ฿ 2,000.00 |
| AW/BT40-ER16-100 | 0.5 - 10 | 100 | 28 | ER16 | ฿ 2,000.00 |
| AW/BT40-ER20-100 | 0.5 - 13 | 100 | 34 | ER20 | ฿ 2,000.00 |
| AW/BT40-ER32-060 | 3.0 - 20 | 60 | 50 | ER32 | ฿ 2,200.00 |
| AW/BT40-ER32-100 | 1.0 - 20 | 100 | 50 | ER32 | ฿ 2,200.00 |
| AW/BT40-ER40-100 | 2.0 - 26 | 100 | 63 | ER40 | ฿ 3,200.00 |
| AW/BT50-ER32-100 | 1.0 - 20 | 100 | 50 | ER32 | ฿ 3,600.00 |
| AW/BT50-ER40-100 | 2.0 - 26 | 100 | 63 | ER40 | ฿ 5,300.00 |
| AW/BT50-ER40-150 | 4.0 - 26 | 150 | 63 | ER40 | ฿ 5,500.00 |

(Price not include Wrench)

ER Collet Chuck (for Normal Milling Machine)
NT Series

| Model No. | Clamping Range | L mm | D mm | Collet Type | Draw Bar | Price |
|------------------|----------------|---------|---------|-------------|-------------|------------|
| | mm | | | | | Baht |
| AW/NT30-ER32-055 | 1.0 - 20 | 55 | 50 | ER32 | M12 X 1.75P | ฿ 2,700.00 |
| AW/NT30-ER40-055 | 2.0 - 26 | 55 | 63 | ER40 | M12 X 1.75P | ฿ 2,900.00 |
| AW/NT40-ER32-050 | 1.0 - 20 | 50 | 50 | ER32 | M16 X 2.0P | ฿ 3,000.00 |
| AW/NT40-ER40-055 | 2.0 - 26 | 55 | 63 | ER40 | M16 X 2.0P | ฿ 3,200.00 |
| AW/NT50-ER40-058 | 2.0 - 26 | 58 | 63 | ER40 | M24 X 3.0P | ฿ 5,300.00 |

(Price not include Wrench)

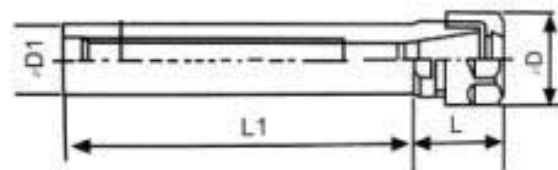
ER Collets Chuck
Straight Shank

| Model No. | D1 | L1 mm | L mm | D mm | Collet Type | Price |
|-----------------|----|----------|---------|---------|-------------|------------|
| | mm | | | | | Baht |
| AW/C20-ER16-100 | 20 | 100 | 30 | 28 | ER16 | ฿ 1,900.00 |
| AW/C20-ER16-150 | 20 | 150 | 30 | 28 | ER16 | ฿ 1,900.00 |
| AW/C20-ER20-100 | 20 | 100 | 36 | 34 | ER20 | ฿ 1,900.00 |
| AW/C20-ER20-150 | 20 | 150 | 36 | 34 | ER20 | ฿ 1,900.00 |

ER Collets

Made in Taiwan



| Model No. | D1 | H | D2 | Price Baht |
|-----------|----|----|--|---------------|
| | mm | mm | mm | |
| AW/ER16 | 17 | 27 | 1, 2, 3, 4, 5, 6, 7, 8, 9, 10 | B 390.00 / pc |
| AW/ER20 | 21 | 31 | 2, 3, 4, 5, 6, 7, 8, 9, 10, 11, 12, 13 | B 390.00 / pc |
| AW/ER32 | 33 | 40 | 3, 4, 5, 6, 7, 8, 9, 10, 11, 12, 13, 14, 15, 16, 17, 18, 19, 20 | B 490.00 / pc |
| AW/ER40 | 41 | 46 | 4, 5, 6, 7, 8, 9, 10, 11, 12, 13, 14, 15, 16, 17, 18, 19, 20, 21, 22, 23, 24, 25, 26 | B 590.00 / pc |

ER Collet Sets

ER16 Collet Sets

ER20 Collet Sets



ER32 Collet Sets

ER40 Collet Sets

| Model No. | Collet | PCS / SET | Price |
|-------------|--|-----------|------------|
| | mm | | Baht |
| AW/ER16 SET | 1, 2, 3, 4, 5, 6, 7, 8, 9, 10 | 10 | B 3,900.00 |
| AW/ER20 SET | 2, 3, 4, 5, 6, 7, 8, 9, 10, 11, 12, 13 | 12 | B 4,900.00 |
| AW/ER32 SET | 4, 5, 6, 8, 10, 12, 13, 15, 16, 18, 20 | 11 | B 5,400.00 |
| AW/ER40 SET | 4, 5, 6, 8, 10, 12, 13, 15, 16, 18, 20, 21, 22, 25, 26 | 15 | B 8,900.00 |

Machine Tools Holder



Locking Device

| Model No. | Type | Price |
|-----------|------|------------|
| | | Baht |
| SL630-00 | BT30 | B 1,300.00 |
| SL630-01 | BT40 | B 1,500.00 |
| SL630-02 | BT50 | B 1,900.00 |



Preset Gauge Z-Zero

| Model No. | Setting | Reading | Accuracy | Price |
|-----------|---------|---------|----------|------------|
| | mm | mm | mm | Baht |
| SL620-01 | 50 | 0.01 | 0.005 | B 3,500.00 |

ASC High Speed Milling Chuck

Made in Taiwan

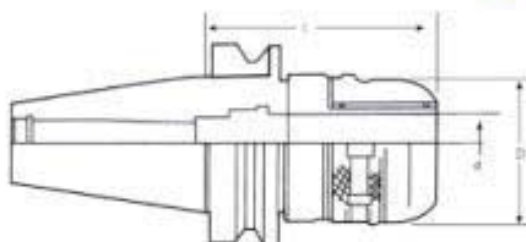

| Model No. | Clamping Range | d | D | L | Collet Type | Price |
|-------------------|----------------|----|----|-----|-------------|------------|
| | mm | mm | mm | mm | | Baht |
| AW/BT30-ASC20-085 | 4 - 20 | 20 | 53 | 85 | SC20 | B 7,900.00 |
| AW/BT40-ASC20-105 | 4 - 20 | 20 | 53 | 105 | SC20 | B 9,900.00 |
| AW/BT40-ASC25-090 | 6 - 25 | 25 | 58 | 90 | SC25 | B 7,900.00 |
| AW/BT40-ASC32-095 | 6 - 32 | 32 | 68 | 95 | SC32 | B 7,900.00 |
| AW/BT50-ASC32-105 | 6 - 32 | 32 | 76 | 105 | SC32 | B 9,900.00 |
| AW/NT40-ASC32-085 | 6 - 32 | 32 | 68 | 85 | SC32 | B 7,900.00 |

Straight Collets

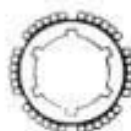
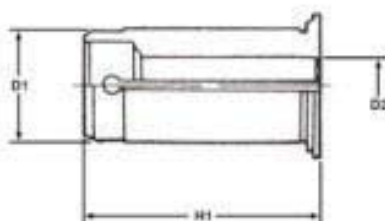

Main Features :

1. Added Chucking Force
2. Anti-Slip Feature
3. Runout Accuracy : 0.005 mm / 100 mm
4. Extreme Rigidity
5. Sub - Zero Treatment

| Model No. | D1 | D2 | H1 | Price |
|-----------|----|------------------------------|----|---------------|
| | mm | mm | mm | Baht |
| AW/SC20 | 20 | 4, 6, 8, 10, 12, 16 | 52 | B 390.00 / pc |
| AW/SC25 | 25 | 6, 8, 10, 12, 16, 20 | 63 | B 390.00 / pc |
| AW/SC32 | 32 | 6, 8, 10, 12, 16, 20, 25 | 71 | B 490.00 / pc |
| AW/SC42 | 42 | 6, 8, 10, 12, 16, 20, 25, 32 | 71 | B 690.00 / pc |

Pull Stud

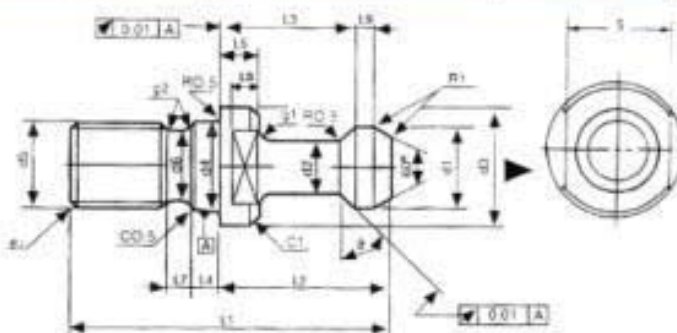

| Model No. | d1 | d2 | d3 | d4 | d5 | L1 | L2 | L3 | L4 | L5 | L7 | L9 | S | t | e | Price |
|------------|----|----|------|------|-----|----|----|----|----|----|----|-----|----|-----|----|----------|
| | mm | mm | mm | mm | mm | mm | mm | mm | mm | mm | mm | mm | mm | mm | | Baht |
| AW/BT30-30 | 11 | 7 | 16.5 | 12.5 | M12 | 43 | 23 | 18 | 4 | 5 | 3 | 2.5 | 13 | 2.5 | 30 | B 190.00 |
| AW/BT30-45 | 11 | 7 | 16.5 | 12.5 | M12 | 43 | 23 | 18 | 4 | 5 | 3 | 2.5 | 13 | 2.5 | 45 | B 190.00 |
| AW/BT30-60 | 11 | 7 | 16.5 | 12.5 | M12 | 43 | 23 | 18 | 4 | 5 | 3 | 2.5 | 13 | 2.5 | 60 | B 190.00 |
| AW/BT40-30 | 15 | 10 | 23 | 17 | M16 | 60 | 35 | 28 | 5 | 6 | 4 | 3 | 19 | 4 | 30 | B 250.00 |
| AW/BT40-45 | 15 | 10 | 23 | 17 | M16 | 60 | 35 | 28 | 5 | 6 | 4 | 3 | 19 | 4 | 45 | B 190.00 |
| AW/BT40-60 | 15 | 10 | 23 | 17 | M16 | 60 | 35 | 28 | 5 | 6 | 4 | 3 | 19 | 4 | 60 | B 250.00 |
| AW/BT40-90 | 15 | 10 | 23 | 17 | M16 | 60 | 35 | 28 | 5 | 6 | 4 | 3 | 19 | 4 | 90 | B 250.00 |
| AW/BT50-30 | 23 | 17 | 38 | 25 | M24 | 85 | 45 | 35 | 8 | 10 | 5 | 5 | 30 | 6 | 30 | B 350.00 |
| AW/BT50-45 | 23 | 17 | 38 | 25 | M24 | 85 | 45 | 35 | 8 | 10 | 5 | 5 | 30 | 6 | 45 | B 290.00 |
| AW/BT50-60 | 23 | 17 | 38 | 25 | M24 | 85 | 45 | 35 | 8 | 10 | 5 | 5 | 30 | 6 | 60 | B 350.00 |
| AW/BT50-90 | 23 | 17 | 38 | 25 | M24 | 71 | 31 | 35 | 8 | 10 | 5 | 5 | 30 | 6 | 90 | B 350.00 |

ASK High Speed Collet Chuck

Made in Taiwan

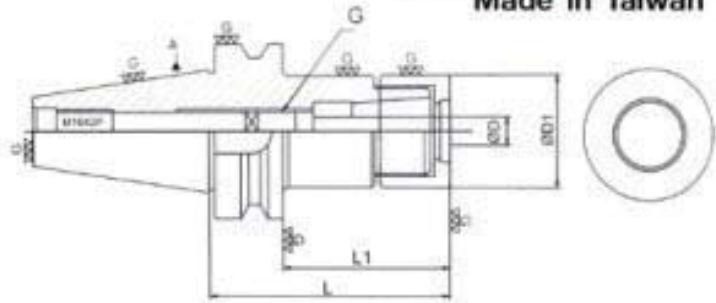

| Model No. | Clamping Range | D1 | L1 | L | Collet Type | Price |
|-------------------|----------------|----|----|-----|-------------|------------|
| | mm | | | | | mm |
| AW/BT30-ASK16-100 | 3 - 16 | 40 | 80 | 100 | ASK16 | B 4,900.00 |
| AW/BT40-ASK16-100 | 3 - 16 | 40 | 75 | 100 | ASK16 | B 5,200.00 |
| AW/BT50-ASK16-100 | 3 - 16 | 40 | 65 | 100 | ASK16 | B 7,900.00 |

ASK High Speed Collet Set

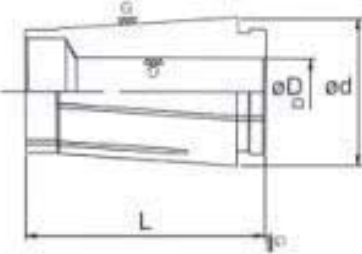

| Model No. | D | Range | d | L | Wrench | Price |
|--------------|----|-----------|------|----|-----------------|-------------------|
| | mm | mm | | | | Baht |
| AW/ASK16 SET | 3 | 3 - 2.75 | 24.6 | 45 | B 1,900.00 / pc | B 12,900.00 / set |
| | 4 | 4 - 3.5 | | | | |
| | 6 | 6 - 5.5 | | | | |
| | 8 | 8 - 7.5 | | | | |
| | 10 | 10 - 9.5 | | | | |
| | 12 | 12 - 11.5 | | | | |
| | 16 | 16 - 15.5 | | | | |

Main Features :

1. ASK tooling system are suitable for high-speed and high precision cutting.
2. Special nuts design provide better cutting conditions and reduce vibrations.
3. Max. Speed 20,000 r.p.m G2.5
4. Max. Runout < 0.01 mm

Pull Stud Mazak

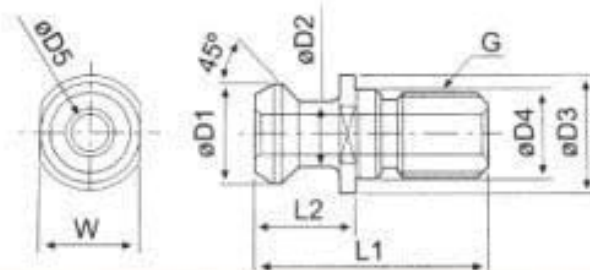

| Model No. | L1 | L2 | D1 | D2 | D3 | D4 | D5 | W | G | Price |
|------------|------|------|------|-------|----|----|----|----|-----|----------|
| | mm | mm | | | | | | | | Baht |
| AW/BT40-45 | 44.1 | 19.1 | 18.8 | 12.45 | 22 | 17 | 7 | 19 | M16 | B 300.00 |

ADS Series High Speed Collet Chuck

Made in Taiwan

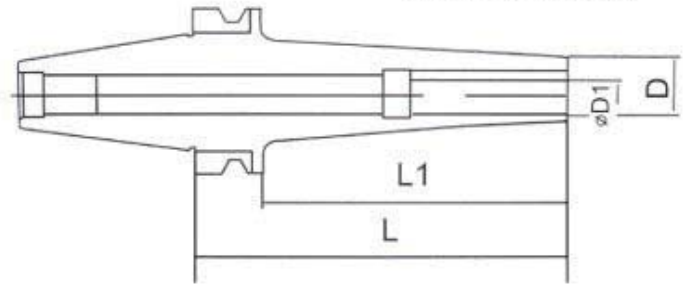

| Model No. | Clamping Range | D | L1 | L | Collet Type | Price |
|-------------------|----------------|----|----|-----|-------------|------------|
| | mm | | | | | mm |
| AW/BT30-ADS08-075 | 3 - 8 | 16 | 55 | 75 | ADS08 | ฿ 6,900.00 |
| AW/BT30-ADS12-080 | 3 - 12 | 23 | 60 | 80 | ADS12 | ฿ 6,900.00 |
| AW/BT40-ADS06-100 | 2 - 6 | 13 | 53 | 100 | ADS06 | ฿ 6,900.00 |
| AW/BT40-ADS08-105 | 3 - 8 | 16 | 80 | 105 | ADS08 | ฿ 7,500.00 |
| AW/BT40-ADS12-090 | 3 - 12 | 23 | 65 | 90 | ADS12 | ฿ 7,500.00 |
| AW/BT50-ADS12-100 | 3 - 12 | 23 | 55 | 100 | ADS12 | ฿ 8,900.00 |

ADS Straight Shank High Speed Chuck

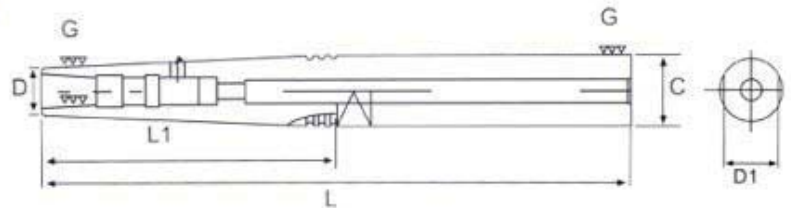

| Model No. | Clamping Range | C | D | L1 | D1 | L | Collet Type | Price |
|------------------|----------------|----|----|-----|----|-----|-------------|------------|
| | mm | | | | | | | mm |
| AW/C16-ADS06-150 | 2 - 6 | 16 | 13 | 38 | 14 | 150 | ADS06 | ฿ 4,900.00 |
| AW/C20-ADS06-200 | 2 - 6 | 20 | 13 | 70 | 17 | 200 | ADS06 | ฿ 5,400.00 |
| AW/C20-ADS08-150 | 3 - 8 | 20 | 16 | 50 | 17 | 150 | ADS08 | ฿ 4,900.00 |
| AW/C20-ADS08-200 | 3 - 8 | 20 | 16 | 100 | 17 | 200 | ADS08 | ฿ 5,400.00 |

ADS Collet

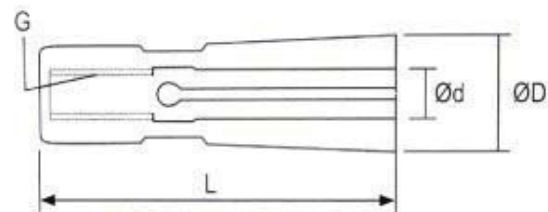

| Model No. | d | D | L | G | Price |
|-----------|-----------------------|-----|----|------------|-----------------|
| | mm | | | | Baht |
| AW/ADS06 | 2, 3, 4, 5, 6 | 9.6 | 36 | M5 X 0.8P | ฿ 2,400.00 / pc |
| AW/ADS08 | 3, 4, 5, 6, 8 | 12 | 37 | M5 X 0.8P | ฿ 2,400.00 / pc |
| AW/ADS12 | 3, 4, 5, 6, 8, 10, 12 | 18 | 63 | M8 X 1.25P | ฿ 2,400.00 / pc |

Main Features :

1. ADS tooling systems are suitable for high-speed and high precision cutting.
2. Tool holder designed without nut that reduce the vibration of cutting.
3. Max. Speed 30,000 r.p.m G2.5
4. Max. Runout < 0.01 mm

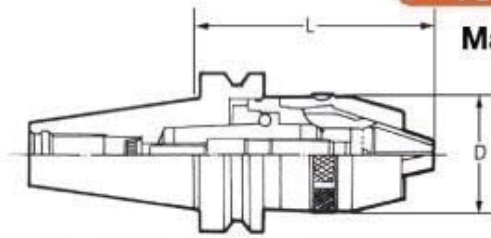
APU Drill Chuck Holder (for CNC Machine)

Made in Taiwan

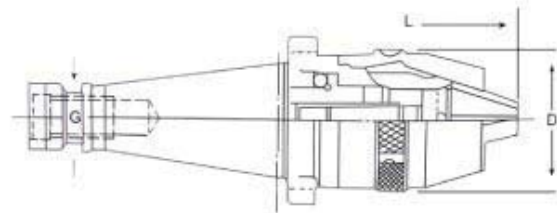
| Model No. | Clamping Range | | D mm | L | | Price Baht |
|-------------------|----------------|------|---------|--------------|--------------|---------------|
| | mm | mm | | Minimum (mm) | Maximum (mm) | |
| AW/BT30-APU13-100 | 1 - 13 | 51.5 | 97 | 104.5 | ฿ 3,600.00 | |
| AW/BT40-APU13-110 | 1 - 13 | 51.5 | 98 | 109 | ฿ 3,600.00 | |
| AW/BT40-APU16-130 | 3 - 16 | 58 | 116 | 130 | ฿ 4,600.00 | |
| AW/BT50-APU13-120 | 1 - 13 | 51.5 | 109 | 120 | ฿ 5,600.00 | |
| AW/BT50-APU16-130 | 3 - 16 | 58 | 116 | 130 | ฿ 6,600.00 | |

APU Drill Chuck Holder (for Normal Milling Machine)

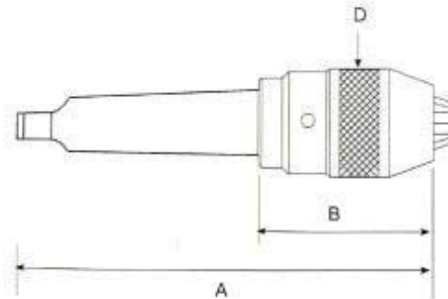
| Model No. | Clamping Range | | D mm | L | | Draw Bar | Price Baht |
|-------------------|----------------|------|---------|--------------|--------------|------------|---------------|
| | mm | mm | | Minimum (mm) | Maximum (mm) | | |
| AW/NT30-APU13-100 | 1 - 13 | 51.5 | 94 | 104.5 | M12 X 1.75P | ฿ 4,400.00 | |
| AW/NT40-APU13-110 | 1 - 13 | 51.5 | 98 | 109 | M16 X 2.0P | ฿ 4,400.00 | |
| AW/NT40-APU16-130 | 3 - 16 | 58 | 116 | 130 | M16 X 2.0P | ฿ 4,600.00 | |

APU Drill Chuck Holder (Morse Taper Shank)

| Model No. | Capacity | | Taper Mount No. DIN or Jacobs | Length (m/m) | | | Weight (g) | Price Baht |
|---------------|----------|------------|-------------------------------------|----------------|------|------|-----------------|---------------|
| | mm | inch | | A | B | D | | |
| | (mm) | (mm) | | (mm) | (mm) | (mm) | | |
| AW/MTA4-APU13 | 0.3 - 13 | 1/64 - 1/2 | MT4 | 206 | 81 | 50 | 1490 | ฿ 3,500.00 |
| AW/MTA4-APU16 | 3 - 16 | 1/8 - 5/8 | MT4 | 212 | 85 | 57 | 1770 | ฿ 3,900.00 |

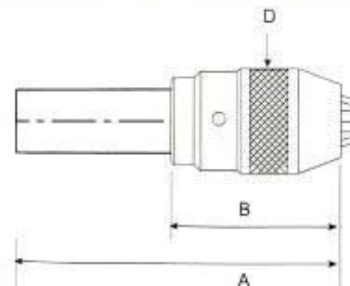
APU Drill Chuck Holder (Straight Shank)

| Model No. | Capacity | | Taper Mount No. DIN or Jacobs | Length (m/m) | | | Weight (g) | Price Baht |
|--------------|----------|------------|-------------------------------------|----------------|------|------|-----------------|---------------|
| | mm | inch | | A | B | D | | |
| | (mm) | (mm) | | (mm) | (mm) | (mm) | | |
| AW/C20-APU13 | 0.3 - 13 | 1/64 - 1/2 | D20 | 141 | 81 | 50 | 1030 | ฿ 3,400.00 |
| AW/C20-APU16 | 3 - 16 | 1/8 - 5/8 | D20 | 145 | 85 | 57 | 1330 | ฿ 3,700.00 |

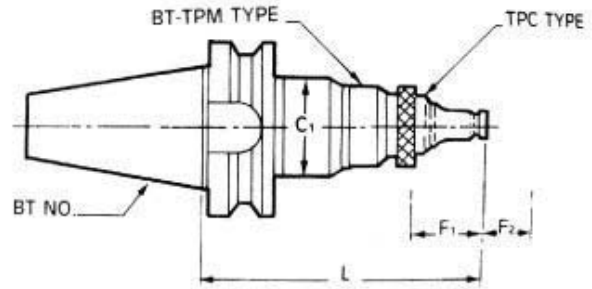
TPM Tap Holder-Tension & Compression Tap Holder
BT Series
Made in Taiwan

| Model No. | C1 | F1 | F2 | L | Tapping Range | Adapter Type | Price Baht |
|----------------|----|----|----|-----|---------------|--------------|------------|
| | mm | mm | mm | mm | | | |
| AW/BT30-TPM316 | 48 | 10 | 20 | 150 | M3 - M16 | TPC316 | B 6,900.00 |
| AW/BT40-TPM316 | 48 | 10 | 20 | 150 | M3 - M16 | TPC316 | B 7,250.00 |
| AW/BT50-TPM316 | 48 | 10 | 20 | 150 | M3 - M16 | TPC316 | B 7,500.00 |
| AW/BT40-TPM830 | 66 | 10 | 25 | 195 | M8 - M30 | TPC830 | B 7,500.00 |
| AW/BT50-TPM830 | 66 | 10 | 25 | 195 | M8 - M30 | TPC830 | B 8,500.00 |

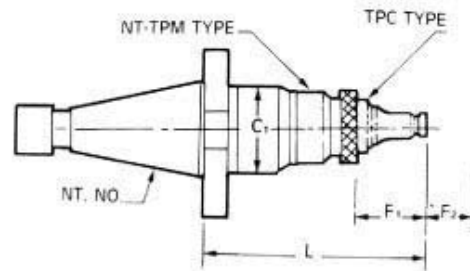
TPM Tap Holder-Tension & Compression Tap Holder
NT Series

| Model No. | C1 | F1 | F2 | L | Tapping Range | Adapter Type | Draw Bolt | Price Baht |
|----------------|----|----|----|-----|---------------|--------------|------------|------------|
| | mm | mm | mm | mm | | | | |
| AW/NT30-TPM316 | 48 | 10 | 20 | 130 | M3 - M16 | TPC316 | M12 X 1.5P | B 6,900.00 |
| AW/NT40-TPM316 | 48 | 10 | 20 | 130 | M3 - M16 | TPC316 | M16 X 2.0P | B 7,250.00 |
| AW/NT40-TPM830 | 66 | 10 | 25 | 160 | M8 - M30 | TPC830 | M16 X 2.0P | B 7,900.00 |

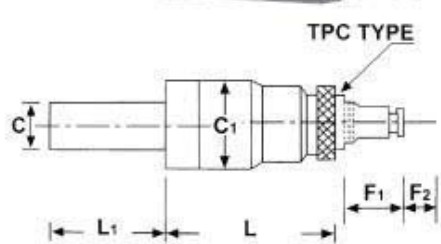
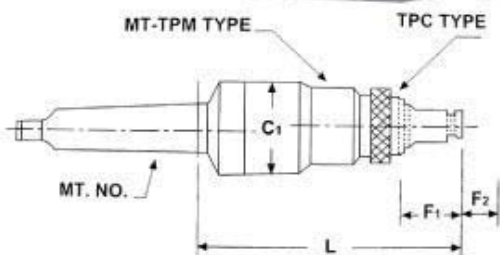
TPM Tap Holder-Tension & Compression Tap Holder
MT Series / Straight Shank

| Model No. | C | C1 | F1 | F2 | L | L1 | Tapping Range | Tap Collet | Price Baht |
|---------------|----|----|----|----|-----|----|---------------|------------|------------|
| | mm | mm | mm | mm | mm | mm | | | |
| AW/MT4-TPM316 | - | 48 | 10 | 20 | 130 | - | M3 - M16 | TPC316 | B 6,500.00 |
| AW/MT5-TPM316 | - | 48 | 10 | 20 | 130 | - | M3 - M16 | TPC316 | B 6,900.00 |
| AW/MT4-TPM830 | - | 66 | 10 | 25 | 180 | - | M8 - M30 | TPC830 | B 7,900.00 |
| AW/MT5-TPM830 | - | 66 | 10 | 25 | 180 | - | M8 - M30 | TPC830 | B 8,500.00 |
| AW/C20-TPM316 | 20 | 48 | 10 | 20 | 100 | 65 | M8 - M16 | TPC316 | B 4,900.00 |

Machine Tools Holder

Tap Collet / TPC316 & TPC830

Made in Taiwan

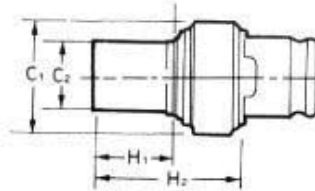

| Model No. | D | H1 | H2 | C1 | C2 | Holder | Price |
|-----------|---|----|----|----|----|--------|-----------------|
| | JIS Standard | mm | mm | mm | mm | Type | Baht |
| AW/TPC316 | M3, M4, M5, M6, M8, M10, M12, M14, M16 | 27 | 47 | 33 | 20 | TPM316 | B 1,500.00 / pc |
| AW/TPC830 | M8, M10, M12, M14, M16, W5/16, W3/4, W7/16, W1/2, W5/8" | 43 | 62 | 51 | 30 | TPM830 | B 1,900.00 / pc |

DT24 / DT33 Drill Taper Set (For Radial Drilling Machine)

DT24 / DT33 Set of Drill Tapper Consists :

1. Tapper Holder (Body) X 1 Pc
2. DT24 / DT33 JTA6 + 1/2 keyless Drill Chuck
3. Tap Sleeves X 2 Pcs
4. Tap Collets X 6 Pcs
5. Adjusting Wrench X 1 Pc



| Model No. | JIS Standard Size | Pcs / Set | Price |
|--------------|--|-----------|-------------|
| | | | Baht |
| AW/DT24 MTA4 | DT24 MTA4 Holder, JTA6+1/2, DT24-M4, M6, M8, M10, M12, M16, DT24-MT1, DT24-MT2 | 10 | B 15,900.00 |
| AW/DT33 MTA4 | DT33 MTA4 Holder, JTA6+1/2, DT33-M8, M10, M12, M16, M20, M24, DT33-MT2, DT33-MT3 | 10 | B 15,900.00 |
| AW/DT33 MTA5 | DT33 MTA5 Holder, JTA6+1/2, DT33-M8, M10, M12, M16, M20, M24, DT33-MT2, DT33-MT3 | 10 | B 16,900.00 |

MTA Morse Taper Holder

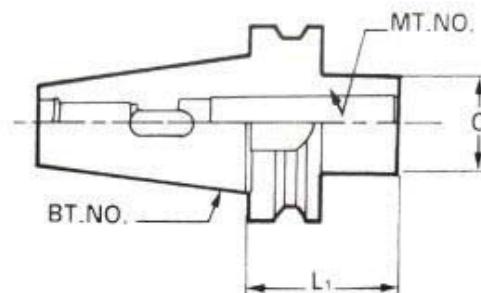

| Model No. | MT No. | L | C | Capacity | | | Price |
|------------------|--------|-----|----|------------|-------------|---------------|------------|
| | | mm | mm | Drill (mm) | Reamer (mm) | End mill (mm) | Baht |
| AW/BT30-MTA1-045 | 1 | 45 | 25 | 2 - 14 | 5 - 14 | 10 - 14 | B 2,200.00 |
| AW/BT30-MTA2-060 | 2 | 60 | 32 | 14 - 23 | 14.5 - 23 | 16 - 22 | B 2,200.00 |
| AW/BT30-MTA3-090 | 3 | 90 | 40 | 23 - 32 | 24 - 32 | 24 - 32 | B 2,200.00 |
| AW/BT40-MTA1-045 | 1 | 45 | 25 | 2 - 14 | 5 - 14 | 10 - 14 | B 2,200.00 |
| AW/BT40-MTA2-045 | 2 | 45 | 32 | 14 - 23 | 14.5 - 23 | 16 - 22 | B 2,200.00 |
| AW/BT40-MTA3-075 | 3 | 75 | 40 | 23 - 32 | 24 - 32 | 24 - 32 | B 2,400.00 |
| AW/BT40-MTA4-090 | 4 | 90 | 50 | 32 - 50 | 32 - 50 | 35 - 50 | B 2,400.00 |
| AW/BT50-MTA2-045 | 2 | 45 | 32 | 14 - 23 | 14.5 - 23 | 16 - 22 | B 3,400.00 |
| AW/BT50-MTA3-045 | 3 | 45 | 40 | 23 - 32 | 24 - 32 | 24 - 32 | B 3,400.00 |
| AW/BT50-MTA4-075 | 4 | 75 | 50 | 32 - 50 | 32 - 50 | 35 - 50 | B 3,400.00 |
| AW/BT50-MTA5-105 | 5 | 105 | 65 | 50 - 75 | 50 | 40 - 75 | B 3,900.00 |

Machine Tools Holder

FMB Face Mill Holder (for CNC Machine)

Made in Taiwan

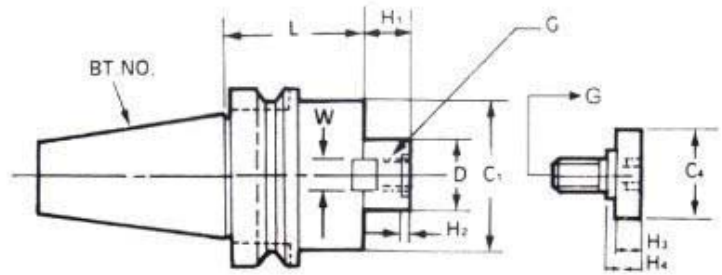

| Model No. | D | L | C1 | H1 | H2 | W | G | C4 | H3 | H4 | Cutter dia. | Price Baht |
|-------------------|----|----|-----|----|----|------|-----|----|----|----|-------------|---------------|
| | mm | mm | mm | mm | mm | mm | mm | mm | mm | mm | | |
| AW/BT30-FMB27-045 | 27 | 45 | 64 | 20 | 4 | 12 | M12 | 32 | 13 | 17 | 80 | ฿ 2,300.00 |
| AW/BT40-FMB27-045 | 27 | 45 | 60 | 20 | 4 | 12 | M12 | 32 | 13 | 17 | 80 | ฿ 2,400.00 |
| AW/BT40-FMB32-045 | 32 | 45 | 63 | 21 | 4 | 14 | M16 | 41 | 16 | 20 | 100 | ฿ 2,400.00 |
| AW/BT40-FMB40-045 | 40 | 45 | 68 | 23 | 4 | 16 | M16 | 47 | 15 | 20 | 100 - 125 | ฿ 2,500.00 |
| AW/BT50-FMB40-045 | 40 | 45 | 85 | 23 | 4 | 16 | M16 | 47 | 15 | 20 | 100 - 125 | ฿ 2,900.00 |
| AW/BT50-FMB60-075 | 60 | 75 | 129 | 32 | 4 | 25.4 | - | - | - | - | 200 | ฿ 5,900.00 |

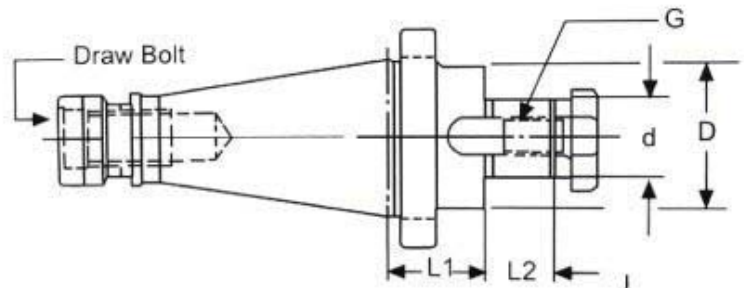
FMB Face Mill Holder (for Normal Milling Machine)

| Model No. | d | L1 | L2 | D | G | Draw Bolt | Price Baht |
|-------------------|----|----|----|-----|-----|-------------|---------------|
| | mm | mm | mm | mm | mm | | |
| AW/NT30-FMB27-020 | 27 | 20 | 20 | 54 | M12 | M12 X 1.75P | ฿ 1,700.00 |
| AW/NT30-FMB32-020 | 32 | 20 | 21 | 59 | M16 | M12 X 1.75P | ฿ 2,000.00 |
| AW/NT40-FMB27-020 | 27 | 20 | 20 | 58 | M12 | M16 X 2.0P | ฿ 2,000.00 |
| AW/NT40-FMB32-020 | 32 | 20 | 21 | 69 | M16 | M16 X 2.0P | ฿ 2,000.00 |
| AW/NT40-FMB40-020 | 40 | 20 | 24 | 80 | M16 | M16 X 2.0P | ฿ 2,000.00 |
| AW/NT40-FMB60-024 | 60 | 24 | 32 | 128 | - | M16 X 2.0P | ฿ 3,900.00 |
| AW/NT50-FMB60-024 | 60 | 24 | 32 | 128 | - | M24 X 3.0P | ฿ 5,100.00 |

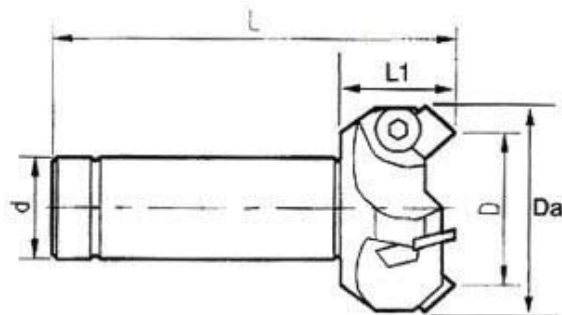
SE445 Face Mill Cutter

| Model No. | D | Da | d | L | L1 | Blade pcs | Insert | Price Baht |
|----------------|----|----|----|-----|----|--------------|----------|---------------|
| | mm | mm | mm | mm | mm | | | |
| AV/SEKN-50X150 | 50 | 62 | 25 | 150 | 45 | 3 | SEKN1203 | ฿ 2,200.00 |

Machine Tools Holder

SE High-Speed Face Mill Cutter

Made in Taiwan

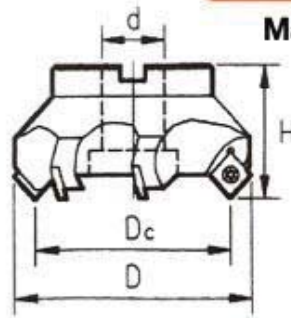

| Model No. | Dc | D | d | H | Blade | Insert | Price |
|-------------|-----|-----|----|----|-------|----------|------------|
| | mm | mm | mm | mm | pcs | | Baht |
| AV/SEET-100 | 100 | 116 | 32 | 55 | 6 | SEET12T3 | ฿ 3,900.00 |
| AV/SEET-125 | 125 | 141 | 40 | 60 | 8 | | ฿ 4,900.00 |
| AV/SEET-150 | 150 | 158 | 40 | 60 | 10 | | ฿ 6,900.00 |

SEET Series Indexable Milling Inserts

YBG202
P10 - P30
M10 - M30

P Vc : 270m/min (180-360)
fz : 0.20mm/r (0.1-0.3)

M Vc : 190m/min (110-270)
fz : 0.20mm/r (0.1-0.3)

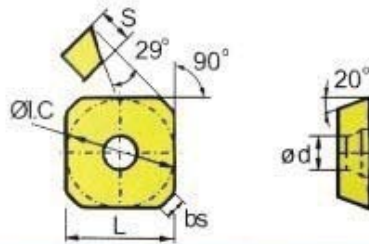

| Type | L | I.C | S | d | bs | Price |
|-------------|------|------|------|-----|------|----------|
| | mm | mm | mm | mm | mm | Baht |
| SEET12T3-DM | 13.4 | 13.4 | 3.97 | 4.1 | 2.55 | ฿ 130.00 |

445 Face Mill Cutter

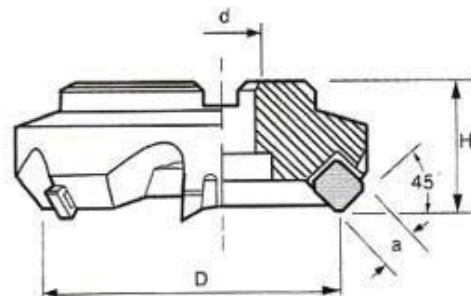

| Model No. | D | d | H | Blade | Insert | Price |
|-------------|-----|----|----|-------|----------|-------------|
| | mm | mm | mm | pcs | | Baht |
| AV/SEKN-080 | 80 | 27 | 50 | 5 | SEKN1203 | ฿ 2,900.00 |
| AV/SEKN-100 | 100 | 32 | 55 | 5 | | ฿ 4,000.00 |
| AV/SEKN-125 | 125 | 40 | 60 | 6 | | ฿ 5,900.00 |
| AV/SEKN-150 | 160 | 40 | 60 | 8 | | ฿ 8,500.00 |
| AV/SEKN-200 | 200 | 60 | 60 | 10 | | ฿ 12,900.00 |
| AV/SEKN-250 | 250 | 60 | 60 | 12 | | ฿ 19,000.00 |

SEKN Series Indexable Milling Inserts

YBG202
P10 - P30
M10 - M30

P Vc : 270m/min (180-360)
fz : 0.20mm/r (0.1-0.3)

M Vc : 190m/min (110-270)
fz : 0.20mm/r (0.1-0.3)

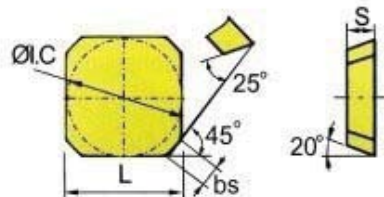

| Type | L | I.C | S | bs | Price |
|--------------|--------|--------|------|-----|----------|
| | mm | mm | mm | mm | Baht |
| SEKN1203AFTN | 12.7 | 12.7 | 3.18 | 1.8 | ฿ 110.00 |
| SEKN1504AFTN | 15.875 | 15.875 | 4.76 | 1.6 | ฿ 150.00 |

Machine Tools Holder

Adjustable Twin Cutter Roughing and Semi-Finishing Boring System



Made in Taiwan

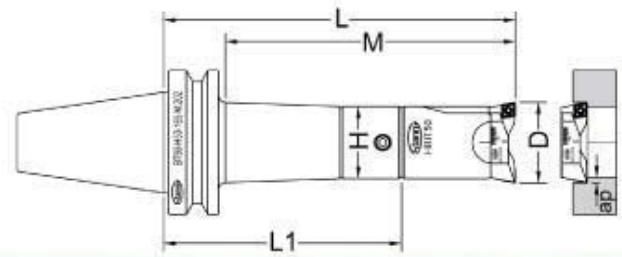

| Model No. | D | | H | M | L1 | L | Adjustable Twin Cutter Boring System | | | Weight | Price |
|--------------------|-----|-----|----|-----|-----|-----|--------------------------------------|-------------|-----------------------|--------|-------------|
| | Min | Max | | | | | Taper Shank | Boring Head | Cutting Insert Holder | | |
| | mm | mm | | | | | | | | mm | mm |
| SN/BT40-HBIT25-123 | 29 | 36 | 25 | 123 | 100 | 150 | BT40-H25-100 | HBIT25 | SACC2936 | 1.64 | ฿ 11,900.00 |
| SN/BT40-HBIT32-150 | 36 | 45 | 32 | 150 | 120 | 183 | BT40-H32-120 | HBIT32 | SACC3645 | 1.92 | ฿ 12,900.00 |
| SN/BT40-HBIT40-162 | 45 | 56 | 40 | 162 | 130 | 193 | BT40-H40-130 | HBIT40 | SACC4556 | 2.51 | ฿ 13,900.00 |
| SN/BT40-HBIT50-182 | 56 | 74 | 50 | 182 | 130 | 210 | BT40-H50-130 | HBIT50 | SACC5674 | 3.30 | ฿ 14,500.00 |
| SN/BT40-HBIT63-102 | 70 | 90 | 63 | 102 | 55 | 135 | BT40-H63-55 | HBIT63 | SACC7090 | 3.02 | ฿ 15,500.00 |
| SN/BT40-HBIT63-102 | 90 | 110 | 63 | 102 | 55 | 135 | BT40-H63-55 | HBIT63 | SACC90110 | 3.14 | ฿ 16,500.00 |

NBH2084 Boring System

3,000 rpm. Ø 8 - Ø 280 mm

Machine Tools Holder

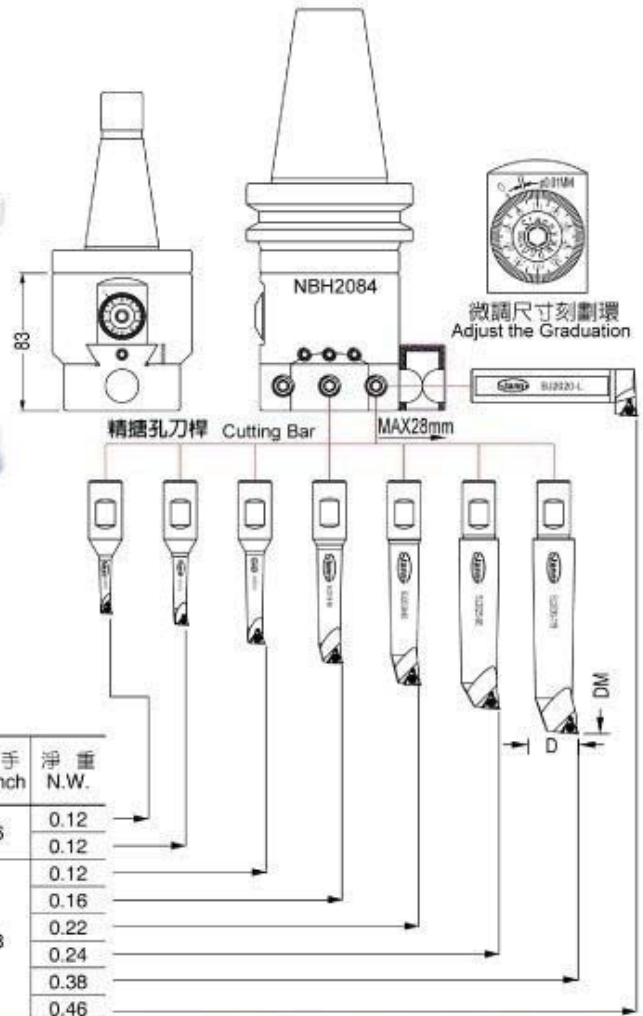

| 精磨孔刀棒 Cutting Bar | 範圍 D Boring Range øDmin-øDmax | 深度 DM | 刀片 Insert | 螺絲 Bolt | 板手 Wrench | 淨重 N.W. |
|----------------------|-------------------------------------|----------|--------------|-------------|--------------|------------|
| BJ2008-32 | 8-11 | 32 | TBG0601..L | SB-1STR-M2 | T6 | 0.12 |
| BJ2010-40 | 10-13 | 40 | | | | 0.12 |
| BJ2012-53 | 12-17 | 53 | TPGH0902..L | SB-2TR-M2.5 | | 0.12 |
| BJ2016-68 | 16-21 | 68 | | | | 0.16 |
| BJ2020-83 | 20-125 | 83 | | | | 0.22 |
| BJ2025-96 | 25-130 | 96 | | | | 0.24 |
| BJ2030-115 | 30-135 | 115 | TPGH1103..L | SB-3TR-M3 | T8 | 0.38 |
| BJ2020-L | 120-280 | 84+BT L1 | | | | 0.46 |

| Model No. | Boring Range | | Taper Shank | Weight | Price |
|-----------------|--------------|-----|-----------------------|--------|-------------|
| | Min | Max | | | |
| | mm | mm | | kg | Baht |
| SN/NT30-NBH2084 | 8 | 280 | DIN2080 ISO30-NBH2084 | 9.8 | ฿ 19,000.00 |
| SN/NT40-NBH2084 | 8 | 280 | DIN2080 ISO40-NBH2084 | 10.3 | ฿ 19,900.00 |
| SN/MT4-NBH2084 | 8 | 280 | DIN228A MT4-NBH2084 | 10.3 | ฿ 19,000.00 |
| SN/BT40-NBH2084 | 8 | 280 | MAS403 BT40-NBH2084 | 9.0 | ฿ 24,900.00 |

H NBJ16 Small Diameter Boring System



Made in Taiwan

6,000 rpm. Ø 6 - Ø 51 mm

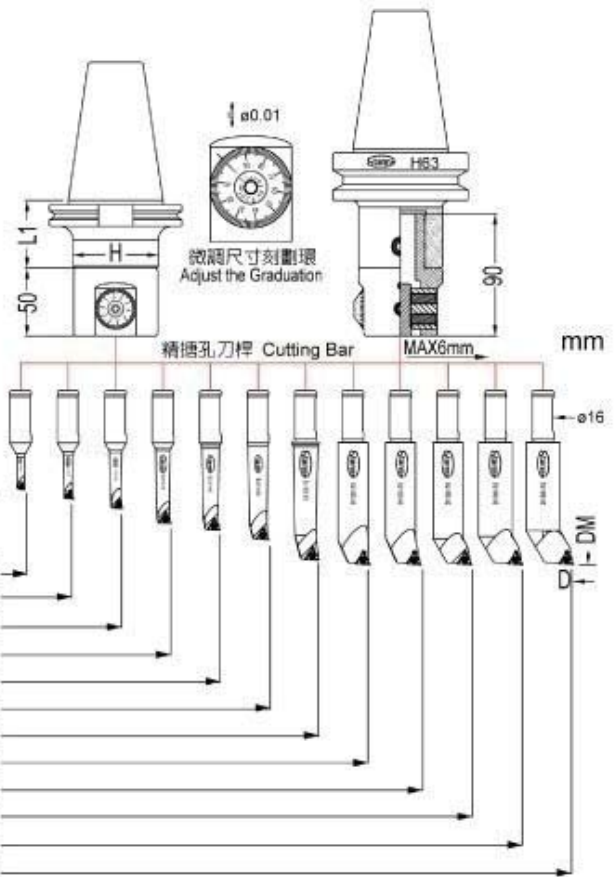

| 插孔刀桿 Cutting Bar | 範圍 D Boring Range øDMin-øDMax | 深度 DM | 刀片 Insert | 螺絲 Bolt | 板手 Wrench | 淨重 N.W |
|---------------------|-------------------------------------|----------|--------------|-------------|--------------|-----------|
| BJ1606-24 | 6-9 | 24 | WBGT0601..L | SB-1STR-M2 | T6 | 0.08 |
| BJ1608-32 | 8-11 | 32 | TBGT0601..L | | | 0.08 |
| BJ1610-40 | 10-13 | 40 | | | | 0.08 |
| BJ1612-53 | 12-15 | 53 | TPGH0902..L | SB-2TR-M2.5 | T8 | 0.10 |
| BJ1614-60 | 14-17 | 60 | | | | 0.10 |
| BJ1616-68 | 16-21 | 68 | | | | 0.12 |
| BJ1620-83 | 20-26 | 83 | TPGH1103..L | SB-3TR-M3 | T8 | 0.20 |
| BJ1625-90 | 25-31 | 90 | | | | 0.30 |
| BJ1630-90 | 30-36 | 90 | | | | 0.32 |
| BJ1635-90 | 35-41 | 90 | | | | 0.32 |
| BJ1640-90 | 40-46 | 90 | | | | 0.38 |
| BJ1645-90 | 45-51 | 90 | | | | 0.38 |

| Model No. | Boring Range | | Taper Shank | H | L1 | Weight | Price |
|----------------|--------------|-----|----------------------|----|----|--------|-------------|
| | Min | Max | | | | | |
| | mm | mm | | mm | mm | kg | Baht |
| SN/NT40-HNBJ16 | 6 | 51 | DIN2080 ISO40-H63-55 | 63 | 55 | 9.3 | B 34,900.00 |
| SN/BT40-HNBJ16 | 6 | 51 | MAS403 BT40-H63-55 | 63 | 55 | 9.1 | B 34,900.00 |
| SN/BT50-HNBJ16 | 6 | 51 | MAS403 BT50 H63-65 | 63 | 65 | 11.7 | B 35,900.00 |

Machine Tools Holder

H BOR50 Micro-Finishing Cutter Fine Boring System



Made in Taiwan

G2.5 12,000 rpm. Ø 6 - Ø 90 mm



Machine Tools Holder

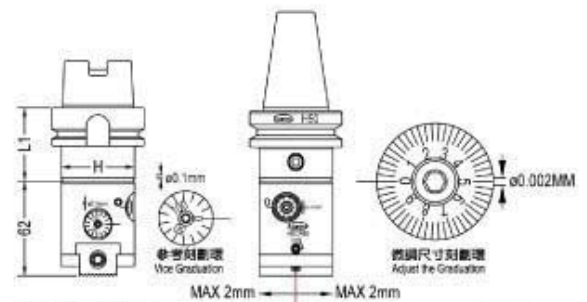

| 精磨孔刀桿 Cutting Bar | 範圍 D Boring Range øDMin-øDMax | 深度 DM | 刀片 Insert | 螺絲 Bolt | 板手 Wrench | 淨重 N.W. |
|----------------------|-------------------------------------|---------------------------------------|--------------|-------------|--------------|------------|
| BR1606-21 | 6-9 | 21 | WBG0601..L | SB-1STR-M2 | T6 | 0.04 |
| BR1608-28 | 8-11 | 28 | TBGT0601..L | | | 0.04 |
| BR1610-35 | 10-13 | 35 | TPGH0902..L | SB-2TR-M2.5 | T8 | 0.05 |
| BR1612-42 | 12-15 | 42 | | | | 0.06 |
| BR1614-50 | 14-17 | 50 | TPGH1103..L | SB-3TR-M3 | T8 | 0.07 |
| BR1616-60 | 16-20 | 60 | | | | 0.09 |
| BR1620-65 | 20-24 | 65 | TPGH1103..L | SB-3TR-M3 | T8 | 0.11 |
| BR1624-68 | 24-28 | 68 | | | | 0.12 |
| BMS | | 60 + SRTP2938 or SRTP3652 or SRTP4468 | | M5x12CAP | Ø 4 | 0.25 |
| SRTP2938 | 29-38 | +10 | TPGH0902..L | SB-2TR-M2.5 | T8 | 0.01 |
| SRTP3652 | 36-52 | +12 | | | | 0.02 |
| SRTP4468 | 44-68 | +12 | | | | 0.03 |
| BM8 | | +SRTP5790 | | M8x20CAP | Ø 6 | 0.03 |
| SRTP5790 | 57-90 | +20 | TPGH1103..L | SB-3TR-M3 | T8 | 0.10 |

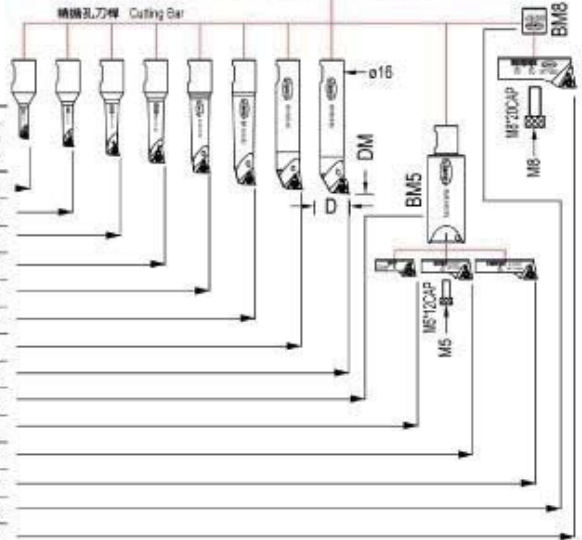

| Model No. | Boring Range | | Taper Shank | H | L1 | Weight | Price |
|----------------|--------------|-----|--------------------|----|----|--------|-------------|
| | Min | Max | | | | | |
| | mm | mm | | mm | mm | kg | Baht |
| SN/BT30-HBOR50 | 6 | 90 | MAS403 BT30-H50-45 | 50 | 45 | 6.7 | ฿ 44,900.00 |
| SN/BT40-HBOR50 | 6 | 90 | MAS403 BT40-H50-50 | 50 | 50 | 7.3 | ฿ 44,900.00 |
| SN/BT50-HBOR50 | 6 | 90 | MAS403 BT50-H50-65 | 50 | 65 | 9.9 | ฿ 45,900.00 |

(Holder for NT30, NT40 Available)

H BOR63 Micro-Finishing Cutter Fine Boring System



Made in Taiwan

G2.5 12,000 rpm. Ø 6 - Ø 150 mm

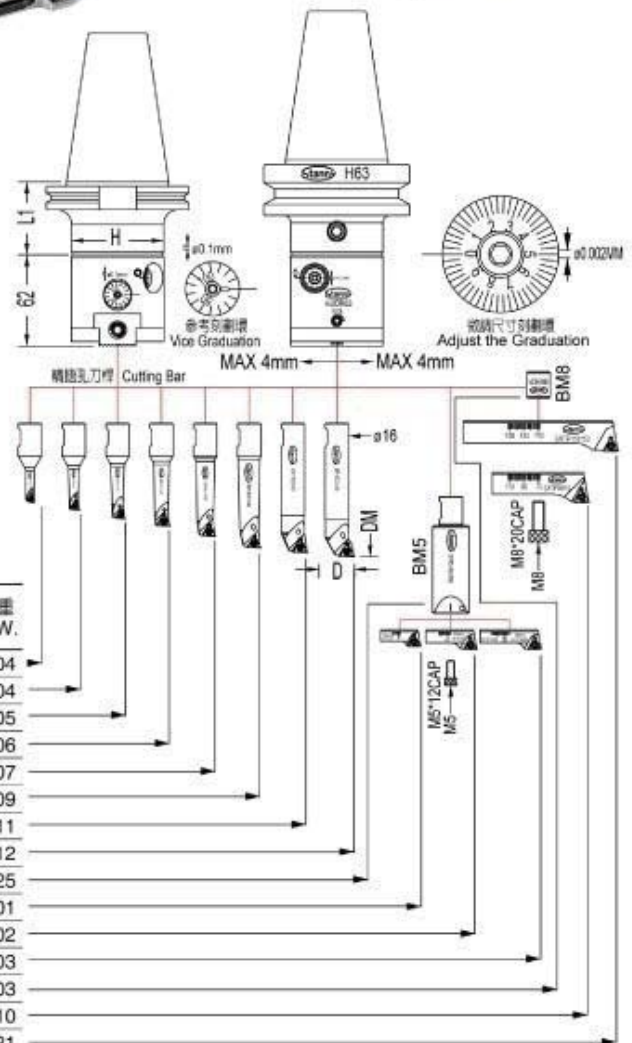

| 精磨孔刀桿 Cutting Bar | 範圍D Boring Range øDMin-øDMax | 深度 DM | 刀片 Insert | 螺絲 Bolt | 扳手 Wrench | 淨重 N.W. |
|----------------------|---------------------------------------|----------|--------------|-------------|--------------|------------|
| BR1606-21 | 6-9 | 21 | WBG0601..L | SB-1STR-M2 | T6 | 0.04 |
| BR1608-28 | 8-11 | 28 | TBG0601..L | | | 0.04 |
| BR1610-35 | 10-13 | 35 | TPGH0902..L | SB-2TR-M2.5 | T8 | 0.05 |
| BR1612-42 | 12-15 | 42 | | | | 0.06 |
| BR1614-50 | 14-17 | 50 | TPGH1103..L | SB-3TR-M3 | T8 | 0.07 |
| BR1616-60 | 16-20 | 60 | | | | 0.09 |
| BR1620-65 | 20-24 | 65 | SB-3TR-M3 | T8 | T8 | 0.11 |
| BR1624-68 | 24-28 | 68 | | | | 0.12 |
| BM5 | 60 + SRTP2938 or SRTP3652 or SRTP4468 | | M5x12CAP | Ø 4 | | 0.25 |
| SRTP2938 | 29-38 | +10 | TPGH0902..L | SB-2TR-M2.5 | T8 | 0.01 |
| SRTP3652 | 36-52 | +12 | | | | 0.02 |
| SRTP4468 | 44-68 | +12 | | | | 0.03 |
| BM8 | +SRTP70110 or SRTP110150 | | M8x20CAP | Ø 6 | | 0.03 |
| SRTP70110 | 70-110 | +20 | TPGH1103..L | SB-3TR-M3 | T8 | 0.10 |
| SRTP110150 | 110-150 | +20 | | | | 0.21 |

| Model No. | Boring Range | | Taper Shank | H | L1 | Weight | Price |
|----------------|--------------|-----|----------------------|----|----|--------|-------------|
| | Min | Max | | | | | |
| | mm | mm | | mm | mm | kg | Baht |
| SN/NT40-HBOR63 | 6 | 150 | DIN2080 ISO40-H63-55 | 63 | 55 | 8.4 | B 48,900.00 |
| SN/BT40-HBOR63 | 6 | 150 | MAS403 BT40-H63-55 | 63 | 55 | 8.2 | B 48,900.00 |
| SN/BT50-HBOR63 | 6 | 150 | MAS403 BT50-H63-65 | 63 | 65 | 10.8 | B 49,900.00 |

Machine Tools Holder